

**SCHEDULE "B"**  
**SOUTH OF GODERICH**  
**WEST WARD**  
**MUNICIPALITY OF CENTRAL HURON**  
**OFFICIAL PLAN**

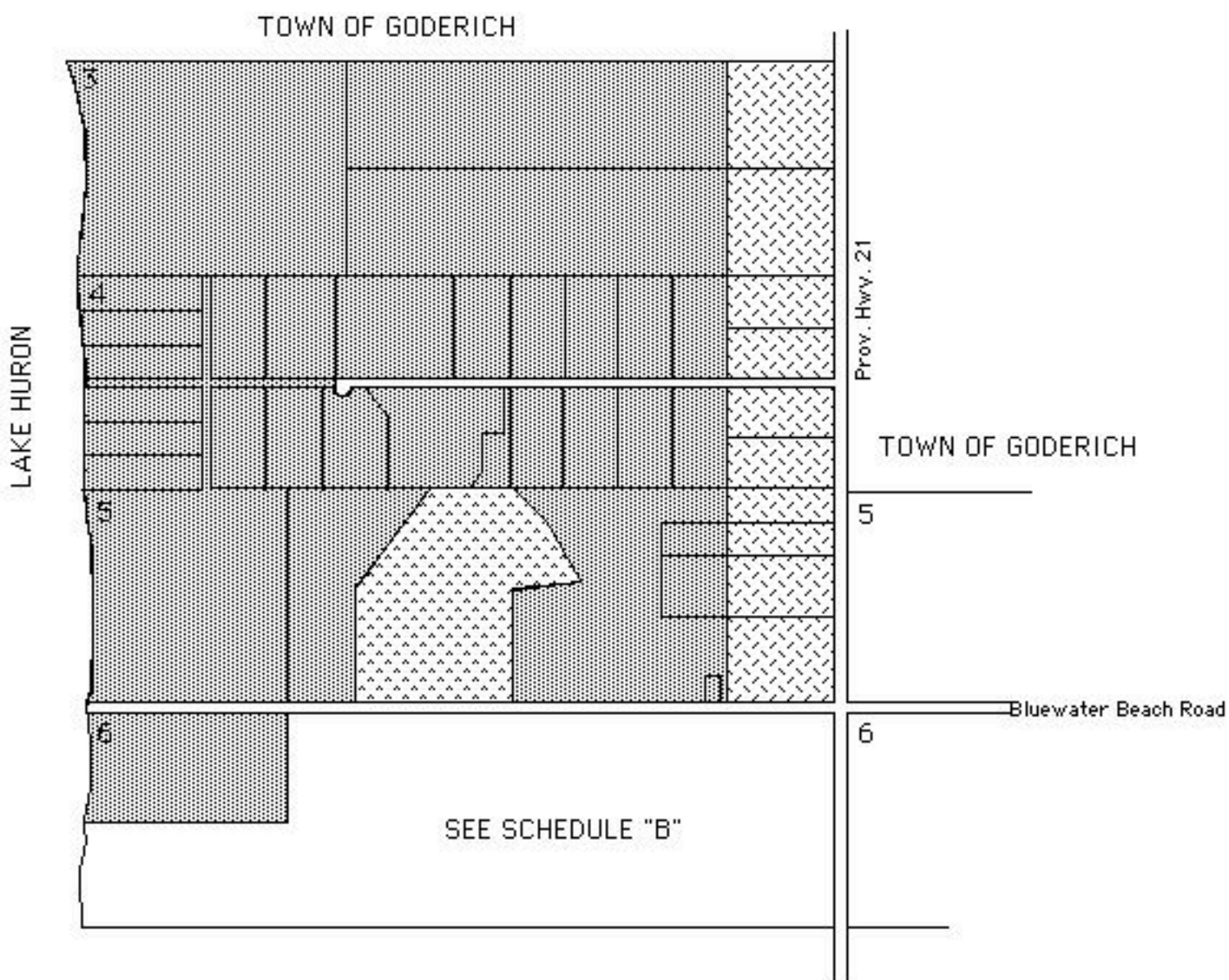

SCALE:



- RESIDENTIAL
- HIGHWAY COMMERCIAL
- NATURAL ENVIRONMENT - LIMITED PROTECTION