

SCHEDULE "B"
 EAST OF GODERICH
 WEST WARD
 MUNICIPALITY OF CENTRAL HURON
 OFFICIAL PLAN

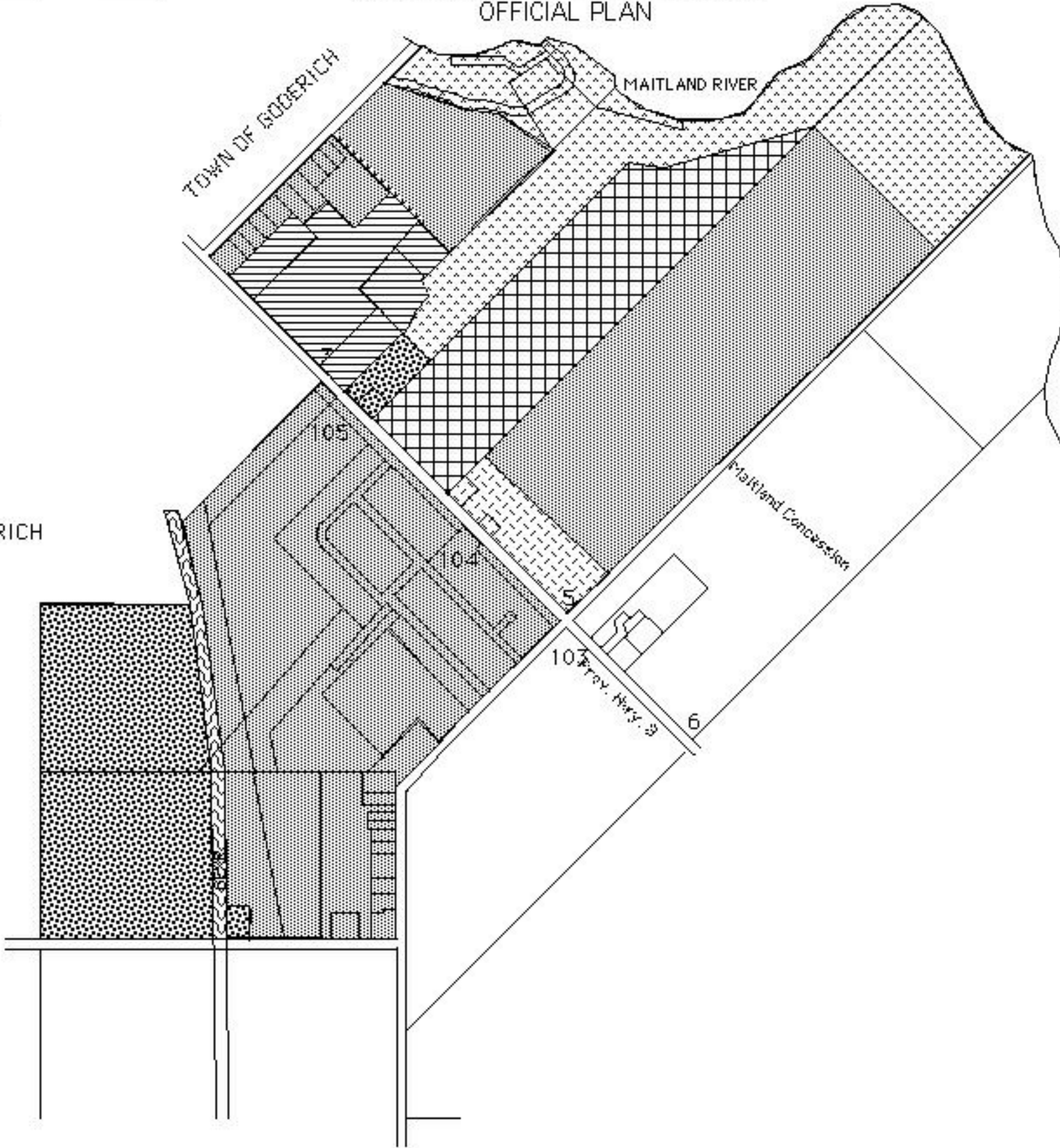

-  RESIDENTIAL
-  COMMUNITY FACILITY
-  NATURAL ENVIRONMENT - FULL PROTECTION
-  INDUSTRIAL
-  HIGHWAY COMMERCIAL
-  COMMERCIAL SHOPPING CENTRE
-  RAILWAY LANDS